

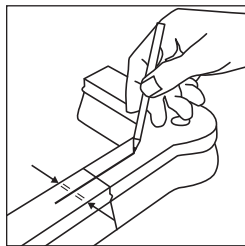

Drill Guide (S-3001 DG) | Driver Align and Drill ZipBolt™ Connection Holes

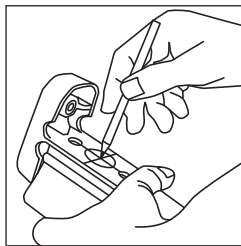

1. Mark a "center line" about 3" long on each piece on the two sections being joined. In this case, it is a quarter turn fitting and a section of straight rail.



3. Using a pencil, mark the spot where the 1" hole on the bottom of rail will be drilled. **IMPORTANT! Drill the 1" hole first before you drill the 3/8" hole.** If not, it is possible that the bit will wobble and create an imperfect hole, and the 1" ZipBolt gear head will not fit properly.

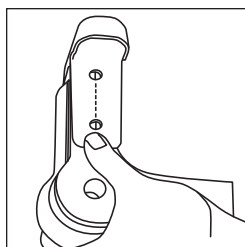

2. Be sure to align the jig with the "center line" by looking through the windows that are part of the jig. Once lined up perfectly using your hand, press the jig firmly into the end cut. It should fit flush against the end.

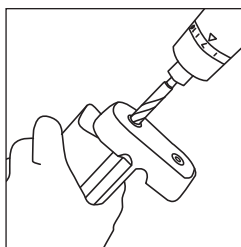

4. It is necessary to flip the jig during the process. The 1/4" hole is most commonly drilled into the fitting to accept the lag portion of the bolt. The 3/8" hole is usually drilled on the side where railbolt tightening takes place.

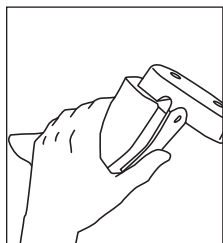

Note: The jig can also be used with an easement. Mark the center line and press firmly into end. Holding the end with one hand, align the flap, bending it to fit the easement. Align the holes through the windows in jig. Once lined up, the flap can be released and hole can be drilled. The "positioning pins" will help hold it in proper position to drill.

After all holes have been drilled, install the ZipBolt™ using the directions provided in each package.



#3001DR

5mm Hex... Install the threaded shaft into the fitting using a wrench or deep well socket.